

**2" x 1 1/4**  
**50,8 x 30,99 mm**  
**Roller 29,21 mm**  
**32B - 1 - 2 - 3**

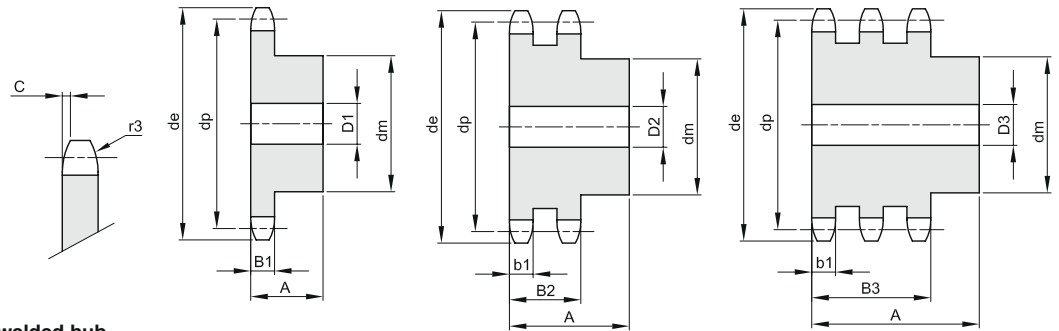

B1	B2	B3	b1	C	r3
29,4	87,4	146	28,8	6	51

Material: Steel C45 / \* Material: Fe - with welded hub

Z	de	dp	simple				double				tripli								
			dm	D1	A	Kg.	dm	D2	A	Kg.	dm	D3	A	Kg.					
8	152,0	132,74	85	30	80	4,20													
9	168,0	148,54	100	30	80	5,78													
10	184,0	164,39	115	30	80	7,60													
11	200,0	181,31	125	30	80	9,26													
12	216,0	196,29	133	30	80	10,91													
13	235,0	212,29	145	30	80	13,05													
14	251,0	228,29	145	30	80	14,25													
15	267,0	244,30	145	30	80	15,53													
16	283,0	260,40	160	30	90	19,87													
17	299,0	276,46	160	30	90	21,35													
18	315,0	292,55	160	30	90	22,92													
19	331,0	308,66	160	30	90	24,53													
20	347,0	324,71	180	40	90	28,50													
21	363,0	340,82	180	40	90	30,36													
22	379,0	356,98	*180	40	90	32,31													
23	396,0	373,08	*180	40	90	34,36													
24	412,0	389,18	*180	40	90	36,50													
25	428,0	405,33	*180	40	90	38,74													
26	444,0	421,44	*180	40	90	41,07													
27	460,0	437,59																	
28	476,0	453,69	*180	40	90	46,01													
29	492,0	469,85																	
30	508,0	486,00	*180	40	90	51,34													
31	525,0	502,13																	
32	541,0	518,27	*200	40	90	59,89													
33	557,0	534,42																	
34	573,0	550,56																	
35	589,0	566,71	*200	40	90	69,16													
36	605,0	582,86																	
37	622,0	599,01																	
38	638,0	615,16	*200	40	90	79,28													
40	670,0	647,47	*200	40	90	86,50													
45	751,0	728,24	*218	40	123	118,87													
50	832,0	809,04	*218	40	123	140,96													
57	945,0	922,16	*218	40	123	175,86													
60	993,0	970,65	*218	40	123	192,24													
76	1252,0	1229,27	*218	40	123	294,00													